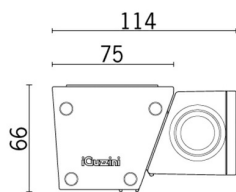

Last information update: May 2024

Product configuration: BI54

BI54: Wall-/Ceiling-mounted - Warm White LED - 100-277V ac - L=1056mm - Wall Grazing Spot Optic

**Product code**BI54: Wall-/Ceiling-mounted - Warm White LED - 100-277V ac - L=1056mm - Wall Grazing Spot Optic **Attention! Code no longer in production****Technical description**

Direct light luminaire, designed to use monochrome LED lamps. Ceiling- and wall-mounted. Consists of a body and supports for installation, to be ordered separately. Extruded aluminium body, with die-cast aluminium end caps complete with silicone seals. Coated with liquid acrylic paint with a high level of weather and UV ray resistance. Lateral control gear box made of PPS (polyphenylene sulfide). The top of the optical assembly is closed by a 3 mm thick transparent glass screen, fixed with silicone. Complete with multi-LED plate in Warm White. Fitted with optics with plastic (methacrylate) lens for Wall Grazing Spot lighting. The lateral box is supplied with a double connector, male/female, with 3-pin quick coupling for pass-through wiring and a closing cap on one side. Set up for pass-through earth wiring. All external screws used are made of A2 stainless steel. The luminaire technical characteristics conform to EN 60598-1 standards and particular requirements.

Installation

Accessories available for installation: $\pm 90^\circ$ adjustable arms L=138mm (code 5576), arms extendable from 309 to 389mm and adjustable $\pm 90^\circ$ (code 5577), bracket for wall-mounting L=350mm (code BZI0), brackets for mounting on balustrades L297mm (code 5578), bracket for surface- or ceiling-mounting L=350mm (code 5570) For a more uniform light beam in the initial few metres, an accessory diffusing filter is available (code BZS9).

Colour

Grey (15)

Weight (Kg)

3.2

Mounting

wall surface/ceiling surface

Wiring

The product is supplied with electronic control gear, 220÷240Vac, 50/60Hz contained in the luminaire. Available for electrical connection: IP66 3-pin female connector (BZI2), IP66 3-pin male connector + closing cap (BZI3), IP66 3-pin male connector + female connector (BZI4), multi-pole cable units with 3-pin male + female connectors (BZJ0-BZJ1-BZJ2)

Notes

Product complete with LED lamp.

Complies with EN60598-1 and pertinent regulations

**Technical data**

Im system:	3382	MacAdam Step:	3
W system:	37	Life Time LED 1:	100,000h - L80 - B10 (Ta 25°C)
Im source:	4450	Life Time LED 2:	100,000h - L80 - B10 (Ta 40°C)
W source:	31	Voltage [Vin]:	230
Luminous efficiency (Im/W, real value):	91.4	Lamp code:	LED
Im in emergency mode:	-	Number of lamps for optical assembly:	1
Total light flux at or above an angle of 90° [Lm]:	0	ZVEI Code:	LED
Light Output Ratio (L.O.R.) [%]:	76	Number of optical assemblies:	1
CRI (minimum):	80	Intervallo temperatura ambiente:	from -30°C to 50°C.
Colour temperature [K]:	3000	Control:	On/off

Polar

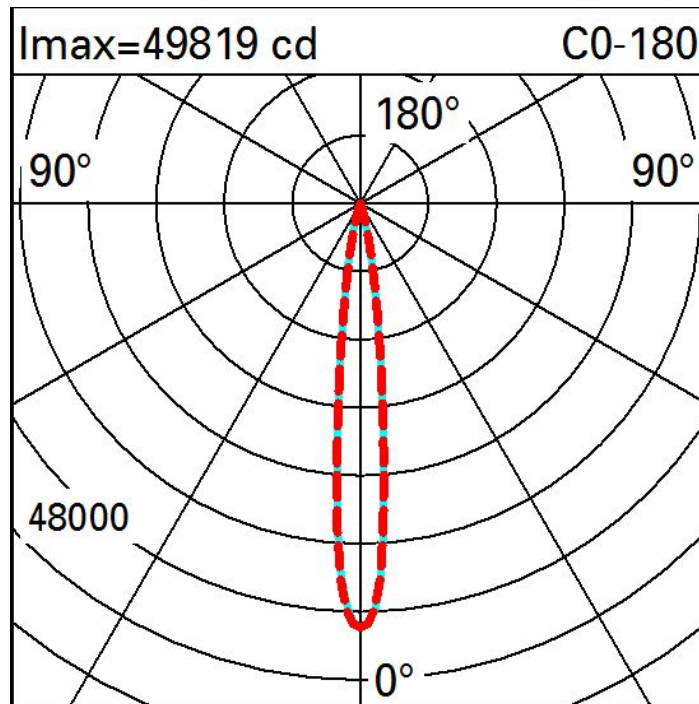

Illuminances

Lux													Wall distance = 1m	
3														
	0.1	0.2	0.7	2	6	14	6	2	0.7	0.2	0.1			
2	0.5	1	2	5	10	14	10	5	2	1	0.5			
	0.8	1	2	5	10	13	10	5	2	1	0.8			
1	0.8	1	2	5	10	16	10	5	2	1	0.8			
	0.7	1	2	5	12	24	12	5	2	1	0.7			
0														
	m	-2	-1		0		1	2	3					