

Last information update: January 2025

Product configuration: RR18

RR18: Dimmable electronic Ø102mm DALI body - Medium optic - Warm White



Product code

RR18: Dimmable electronic Ø102mm DALI body - Medium optic - Warm White

Technical description

Adjustable spotlight with adapter for installation on an electrified track or base. High chromatic yield LED lamp with Warm White (3000K) tone and OptiBeam Lens optic system and Medium optic. Dimmable electronic DALI power supply integrated in product. Luminaire made of die-cast aluminium and thermoplastic material that allows a 360° rotation about the vertical axis and 90° tilting relative to the horizontal plane with mechanical aiming locks. Passive heat dissipation. Spotlight with "Push&Go" system designed to hold up to two flat accessories at the same time. The same system can also be used to apply another external component selected from the directional flaps and anti-glare screen. All internal accessories rotate 360° about the spotlight longitudinal axis.

Installation

Installation on an electrified track or base.

Colour

White (01) | Black (04)

Weight (Kg)

1.33

Mounting

wall surface|ceiling surface

Wiring

Electronic components integrated in product

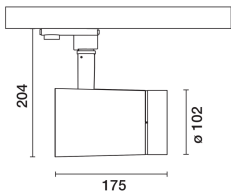

Complies with EN60598-1 and pertinent regulations



Technical data

Im system:	1600	CRI (minimum):	97
W system:	19.9	Colour temperature [K]:	3000
Im source:	1860	MacAdam Step:	2
W source:	18	Life Time LED 1:	> 50,000h - L90 - B10 (Ta 25°C)
Luminous efficiency (lm/W, real value):	80.4	Lamp code:	LED
Im in emergency mode:	-	Number of lamps for optical assembly:	1
Total light flux at or above an angle of 90° [Lm]:	0	ZVEI Code:	LED
Light Output Ratio (L.O.R.) [%]:	86	Number of optical assemblies:	1
Beam angle [°]:	16°	Control:	DALI-2

Polar

